



**VENUS**  
height 1720 mm, lenght 595 mm. Standard White finish (cod. 01).



**Technical features:**

- steel towel warmer radiator
- horizontal elements featuring round tubes with a 23 mm diameter
- side manifolds with a 40x30 mm semioval section
- manifold threading and central connections (50 mm) 1/2" Gas right
- maximum working pressure 8 bar
- maximum working temperature 95°C

**Price included:**

- 4 white infratube for wall fixing for VENUS white and 4 chromed infratube for wall fixing for VENUS coloured
- 1/2" air vent

**Finishes available      Surcharge**

- Standard White
- Classic finished
- Special finished
- Other RAL colors

Finishing codes see page 596.

**Connections**

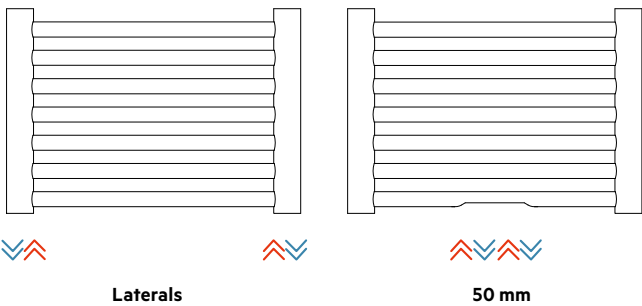

**Connection dimensions with IRSAP valves**

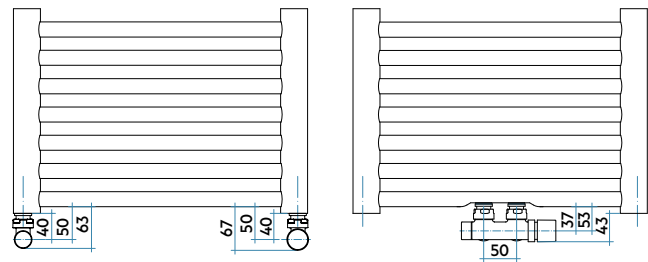

For other types of connections see pag. 414

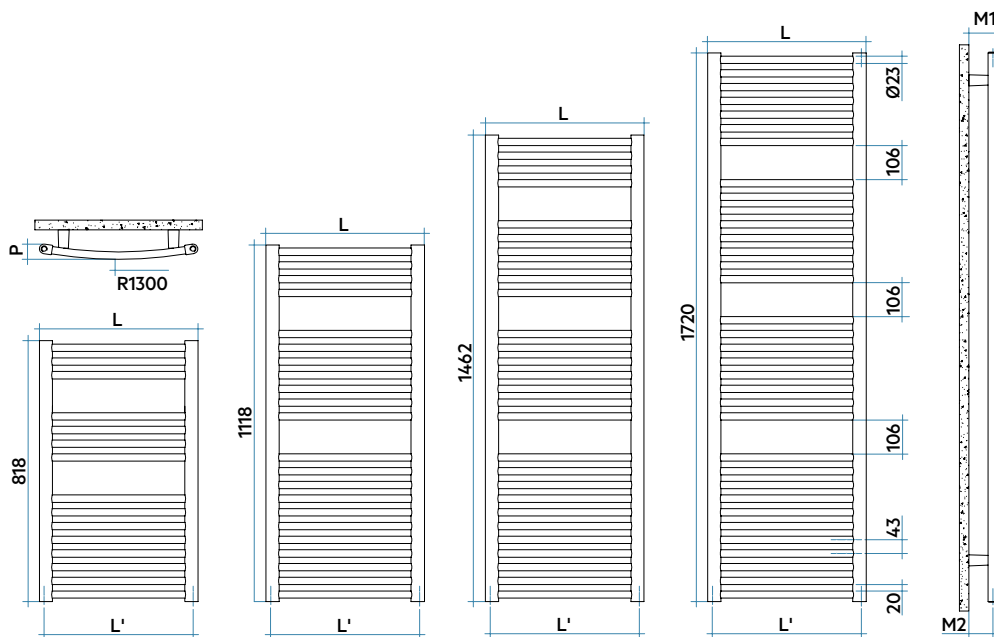

L mm	P mm	M1 mm	M2 mm
448	43	91÷106	65÷80
497	48	92÷107	60÷75
595	57	97÷112	54÷69
740	76	102÷117	42÷54



Model	Code	Depth mm	Height mm	Width mm	Conn. centre mm	Weight Kg	Cap. lt	Btu/h	Thermal Power				
									Δt=50°C Watt	Δt=40°C Watt	Δt=30°C Watt (*)	Δt=20°C Watt	
818 15 rails 2 espaces	MIS045 B 01 IR 01 NNN	43	818	448	418	4,7	3,5	1147	336	257	181	111	1,207
	MIS050 B 01 IR 01 NNN	48	818	497	467	5,0	3,8	1248	366	280	198	121	1,207
	MIS060 B 01 IR 01 NNN	57	818	595	565	5,8	4,3	1452	426	325	230	141	1,206
	MIS075 B 01 IR 01 NNN	76	818	740	710	8,9	4,8	1757	515	393	278	171	1,206
1118 22 rails 2 espaces	MIM045 B 01 IR 01 NNN	43	1118	448	418	6,6	5,0	1617	474	360	253	153	1,231
	MIM050 B 01 IR 01 NNN	48	1118	497	467	7,2	5,4	1774	520	395	278	169	1,227
	MIM060 B 01 IR 01 NNN	57	1118	595	565	8,2	6,1	2088	612	466	329	201	1,218
	MIM075 B 01 IR 01 NNN	76	1118	740	710	12,8	6,9	2556	749	572	405	248	1,205
1462 28 rails 3 espaces	MIL045 B 01 IR 01 NNN	43	1462	448	418	8,5	6,4	2098	615	468	329	200	1,226
	MIL050 B 01 IR 01 NNN	48	1462	497	467	9,2	6,9	2300	674	513	360	219	1,226
	MIL060 B 01 IR 01 NNN	57	1462	595	565	10,5	7,9	2702	792	603	424	258	1,224
	MIL075 B 01 IR 01 NNN	76	1462	740	710	16,3	8,8	3304	968	737	519	316	1,221
1720 34 rails 3 espaces	MIG045 B 01 IR 01 NNN	43	1720	448	418	10,2	7,7	2525	740	563	396	241	1,226
	MIG050 B 01 IR 01 NNN	48	1720	497	467	11,0	8,3	2767	811	617	434	264	1,224
	MIG060 B 01 IR 01 NNN	57	1720	595	565	12,6	9,5	3248	952	725	511	311	1,220
	MIG075 B 01 IR 01 NNN	76	1720	740	710	19,7	10,6	3968	1163	887	626	383	1,213

Mix. Funct.	Code
300	ANRES300WDI
400	ANRES400WDI
400	ANRES400WDI
400	ANRES400WDI
400	ANRES400WDI
400	ANRES400WDI
700	ANRES700WDI
700	ANRES700WDI
700	ANRES700WDI
700	ANRES700WDI
1000	ANRES1000WDI
700	ANRES700WDI
700	ANRES700WDI
1000	ANRES1000WDI
1000	ANRES1000WDI

(\*) Thanks to the high performance of Irsap VENUS radiators, the ideal Δt for low temperature projects is Δt at 30°C.

For Δt different from 50°C use the formula:  $Q = Q_n (\Delta t / 50)^n$

To order a radiator in the mixed version put the code of the Standard version + the code of the corresponding electric heater

Example: Mod. 1462 x 740: **MIL075 B 01 IR 01 NNN** (€ 207,84) + **ANRES1000WDI** (€ 197,29) = Tot. € 405,13

### Key Codes

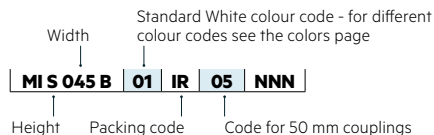
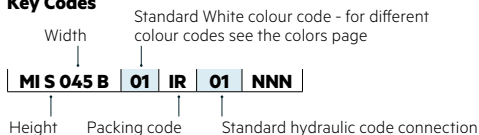

### Decorative & Technical Accessories

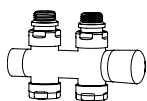

Kit Valves and Lockshield valve  
Pag. 562

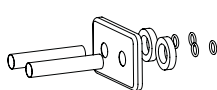

Pipe cover kit  
Pag. 566

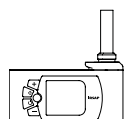

Electronic Control  
Pag. 574

