



**TESI 3**

14 elements, height 1865 mm, length 630 mm. Ivory finish (cod. 02). Configuration cod. 02.



**Technical features:**

- tubes made of 25 mm diameter sheet steel
- manifolds made of pressed sheet steel
- elements 45 mm long (element pitch)
- threading 1"1/4 G right and left on top and bottom manifold
- maximum working pressure 10 bar
- maximum working temperature 95°C

**TESI is available, on request, in some heights not included in this price list. For feasibility and cost ask our commercial service (customer care).**

The union of several coils, to obtain radiators of non-indicated lengths, can be carried out with a simple nipple operation (see nipple table on page 59).

Finishes available	Surcharge
Standard White	
Classic finishes	
Special finishes	
Loft finishes (cod. TR)	
Other RAL colors	

**Finishing codes see page 596.**

**Valves**

IRSAP valves can be supplied to match the radiator.  
To select the type of valve suitable for the connection, see the Accessories section pag. 562.

**Prices included**

- 4 universal brackets for TESI (except for very small batteries) (fig. 1)
- 4 connections with reductions 1"1/4 to 1/2" for TESI white and colored, mounted on the radiator (fig. 2)
- 1 1/2" air vent (fig. 3)
- 1 cover for 1/2" blind plug (fig. 4)



Fig. 1



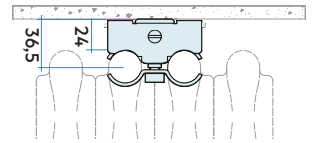
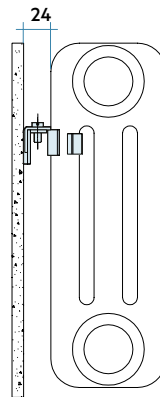
Fig. 2

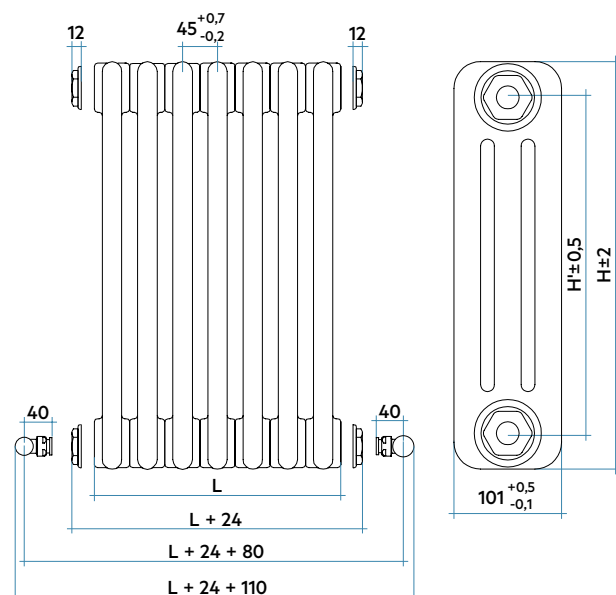


Fig. 3



Fig. 4





### Total width of the TESI radiator:

L (TESI size) = No. of elements x 45  
 L + 24 mm (12+12) = TESI size with caps  
 L + 24 mm (12+12) + 80 mm (40+40) = Low water inlet hydraulic centre distance (right and left) with IRSAP valves and caps  
 L + 24 mm (12+12) + 110 mm = **Total overall dimensions**



Model	Code	Depth mm	Height H mm	Conn. centre H' mm	Weigh Kg	Capacity lt	Thermal Power				Exp. n.	
							$\Delta t=50^{\circ}\text{C}$ Btu/h	$\Delta t=50^{\circ}\text{C}$ Watt	$\Delta t=40^{\circ}\text{C}$ Watt	$\Delta t=30^{\circ}\text{C}$ Watt (*)		$\Delta t=20^{\circ}\text{C}$ Watt
200	RT 3 0200 YY 01 A4 02 N	101	200	127	0,41	0,46	59,5	<b>20,3</b>	15,2	<b>10,5</b>	6,2	1,290
300	RT 3 0300 YY 01 A4 02 N	101	300	235	0,60	0,60	95,4	<b>32,5</b>	24,6	<b>17,2</b>	10,4	1,250
350	RT 3 0350 YY 01 A4 02 N	101	350	285	0,69	0,66	109,5	<b>37,3</b>	28,2	<b>19,7</b>	11,8	1,250
365	RT 3 0365 YY 01 A4 02 N	101	365	300	0,72	0,68	113,6	<b>38,7</b>	29,3	<b>20,4</b>	12,3	1,260
400	RT 3 0400 YY 01 A4 02 N	101	400	335	0,78	0,72	123,3	<b>42,0</b>	31,7	<b>22,1</b>	13,3	1,260
450	RT 3 0450 YY 01 A4 02 N	101	450	385	0,87	0,79	137,1	<b>46,7</b>	35,2	<b>24,5</b>	14,7	1,260
500	RT 3 0500 YY 01 A4 02 N	101	500	435	0,96	0,85	150,7	<b>51,4</b>	38,7	<b>26,9</b>	16,0	1,270
535	RT 3 0535 YY 01 A4 02 N	101	535	470	1,02	0,89	160,2	<b>54,6</b>	41,1	<b>28,5</b>	17,0	1,270
550	RT 3 0550 YY 01 A4 02 N	101	550	485	1,05	0,91	164,0	<b>55,9</b>	42,1	<b>29,1</b>	17,4	1,280
565	RT 3 0565 YY 01 A4 02 N	101	565	500	1,07	0,93	168,3	<b>57,4</b>	43,1	<b>29,9</b>	17,8	1,280
600	RT 3 0600 YY 01 A4 02 N	101	600	535	1,14	0,97	177,8	<b>60,6</b>	45,5	<b>31,5</b>	18,7	1,280
650	RT 3 0650 YY 01 A4 02 N	101	650	585	1,23	1,03	191,2	<b>65,2</b>	48,9	<b>33,8</b>	20,0	1,290
665	RT 3 0665 YY 01 A4 02 N	101	665	600	1,25	1,05	195,2	<b>66,5</b>	49,9	<b>34,5</b>	20,4	1,290
685	RT 3 0685 YY 01 A4 02 N	101	685	620	1,29	1,08	200,5	<b>68,3</b>	51,2	<b>35,4</b>	21,0	1,290
750	RT 3 0750 YY 01 A4 02 N	101	750	685	1,40	1,16	218,2	<b>74,4</b>	55,7	<b>38,3</b>	22,7	1,300
765	RT 3 0765 YY 01 A4 02 N	101	765	700	1,43	1,18	221,8	<b>75,6</b>	56,6	<b>38,9</b>	23,0	1,300
815	RT 3 0815 YY 01 A4 02 N	101	815	750	1,52	1,24	235,1	<b>80,1</b>	59,9	<b>41,2</b>	24,3	1,300
865	RT 3 0865 YY 01 A4 02 N	101	865	800	1,61	1,30	248,4	<b>84,6</b>	63,2	<b>43,4</b>	25,5	1,310
885	RT 3 0885 YY 01 A4 02 N	101	885	820	1,64	1,33	253,6	<b>86,4</b>	64,5	<b>44,2</b>	26,0	1,310
900	RT 3 0900 YY 01 A4 02 N	101	900	835	1,67	1,35	257,6	<b>87,8</b>	65,5	<b>44,9</b>	26,3	1,310
1000	RT 3 1000 YY 01 A4 02 N	101	1000	935	1,85	1,47	284,0	<b>96,8</b>	72,2	<b>49,4</b>	29,0	1,320
1200	RT 3 1200 YY 01 A4 02 N	101	1200	1135	2,37	1,70	336,7	<b>114,8</b>	85,5	<b>58,4</b>	34,2	1,320
1500	RT 3 1500 YY 01 A4 02 N	101	1500	1435	2,95	2,07	415,9	<b>141,7</b>	105,3	<b>71,9</b>	41,9	1,330
1800	RT 3 1800 YY 01 A4 02 N	101	1800	1735	3,54	2,43	495,7	<b>168,9</b>	125,7	<b>85,8</b>	50,2	1,330
2000	RT 3 2000 YY 01 A4 02 N	101	2000	1935	3,93	2,68	549,3	<b>187,2</b>	139,5	<b>95,5</b>	56,0	1,318
2200	RT 3 2200 YY 01 A4 02 N	101	2200	2135	4,32	2,92	603,5	<b>205,7</b>	153,5	<b>105,3</b>	61,9	1,310
2500	RT 3 2500 YY 01 A4 02 N	101	2500	2435	4,90	3,29	685,8	<b>233,7</b>	174,9	<b>120,4</b>	71,1	1,299

(\*) Thanks to the high performance of Irsap TESI 3 radiators, the ideal  $\Delta t$  for low temperature projects is  $\Delta t$  at  $30^{\circ}\text{C}$ .

For  $\Delta t$  different from  $50^{\circ}\text{C}$  use the formula:  $Q=Q_n (\Delta t / 50)^n$

### Key Codes

Standard White colour code.  
 For different colour codes see the colours page 596

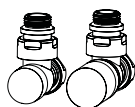
RT 3 0200 YY 01 A4 02 N

Number of elements

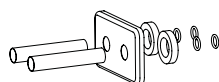
Packing code

Radiator with plugs assembled. For other configurations and water connections see page 54

### Decorative & Technical Accessories



Kit Valves and Lockshield valve  
 Pag. 562



Pipe cover kit  
 Pag. 566



### RADIATORS' DATA (LENGTHS WITHOUT BUSHES)

		HEIGHT														
		200	300	350	365	400	450	500	535	550	565	600	650	665	685	
<b>Lenght mm</b>	<b>90</b>	W	41	65	75	77	84	93	103	109	112	115	121	130	133	137
	yy = N° elem.		2													
<b>Lenght mm</b>	<b>135</b>	W	61	98	112	116	126	140	154	164	168	172	182	195	200	205
	yy = N° elem.		3													
<b>Lenght mm</b>	<b>180</b>	W	81	130	149	155	168	187	205	218	224	229	242	261	266	273
	yy = N° elem.		4													
<b>Lenght mm</b>	<b>225</b>	W	101	163	187	194	210	234	257	273	280	287	303	326	333	342
	yy = N° elem.		5													
<b>Lenght mm</b>	<b>270</b>	W	122	195	224	232	252	280	308	328	335	344	363	391	399	410
	yy = N° elem.		6													
<b>Lenght mm</b>	<b>315</b>	W	142	228	261	271	294	327	360	382	391	402	424	456	466	478
	yy = N° elem.		7													
<b>Lenght mm</b>	<b>360</b>	W	162	260	298	310	336	374	411	437	447	459	485	521	532	547
	yy = N° elem.		8													
<b>Lenght mm</b>	<b>405</b>	W	183	293	336	348	378	420	462	491	503	516	545	586	599	615
	yy = N° elem.		9													
<b>Lenght mm</b>	<b>450</b>	W	203	325	373	387	420	467	514	546	559	574	606	652	665	683
	yy = N° elem.		10													
<b>Lenght mm</b>	<b>495</b>	W	223	358	410	426	462	514	565	601	615	631	666	717	732	752
	yy = N° elem.		11													
<b>Lenght mm</b>	<b>540</b>	W	243	390	448	465	504	561	616	655	671	688	727	782	798	820
	yy = N° elem.		12													
<b>Lenght mm</b>	<b>585</b>	W	264	423	485	503	546	607	668	710	727	746	788	847	865	888
	yy = N° elem.		13													
<b>Lenght mm</b>	<b>630</b>	W	284	455	522	542	588	654	719	764	783	803	848	912	931	957
	yy = N° elem.		14													
<b>Lenght mm</b>	<b>675</b>	W	304	488	560	581	630	701	771	819	839	861	909	977	998	1025
	yy = N° elem.		15													
<b>Lenght mm</b>	<b>720</b>	W	325	520	597	620	672	748	822	874	894	918	969	1042	1064	1093
	yy = N° elem.		16													
<b>Lenght mm</b>	<b>765</b>	W	345	553	634	658	715	794	873	928	950	975	1030	1108	1131	1162
	yy = N° elem.		17													
<b>Lenght mm</b>	<b>810</b>	W	365	585	671	697	757	841	925	983	1006	1033	1090	1173	1197	1230
	yy = N° elem.		18													
<b>Lenght mm</b>	<b>855</b>	W	386	618	709	736	799	888	976	1037	1062	1090	1151	1238	1264	1298
	yy = N° elem.		19													
<b>Lenght mm</b>	<b>900</b>	W	406	650	746	774	841	934	1027	1092	1118	1147	1212	1303	1330	1367
	yy = N° elem.		20													
<b>Lenght mm</b>	<b>945</b>	W	426	683	783	813	883	981	1079	1147	1174	1205	1272	1368	1397	1435
	yy = N° elem.		21													
<b>Lenght mm</b>	<b>990</b>	W	446	715	821	852	925	1028	1130	1201	1230	1262	1333	1433	1463	1503
	yy = N° elem.		22													
<b>Lenght mm</b>	<b>1035</b>	W	467	748	858	891	967	1075	1182	1256	1286	1320	1393	1498	1530	1572
	yy = N° elem.		23													
<b>Lenght mm</b>	<b>1080</b>	W	487	780	895	929	1009	1121	1233	1310	1342	1377	1454	1564	1596	1640
	yy = N° elem.		24													
<b>Lenght mm</b>	<b>1125</b>	W	507	813	933	968	1051	1168	1284	1365	1398	1434	1515	1629	1663	1709
	yy = N° elem.		25													
<b>Lenght mm</b>	<b>1170</b>	W	528	845	970	1007	1093	1215	1336	1420	1453	1492	1575	1694	1730	1777
	yy = N° elem.		26													
<b>Lenght mm</b>	<b>1215</b>	W	548	878	1007	1045	1135	1261	1387	1474	1509	1549	1636	1759	1796	1845
	yy = N° elem.		27													
<b>Lenght mm</b>	<b>1260</b>	W	568	910	1044	1084	1177	1308	1438	1529	1565	1606	1696	1824	1863	1914
	yy = N° elem.		28													
<b>Lenght mm</b>	<b>1305</b>	W	588	943	1082	1123	1219	1355	1490	1583	1621	1664	1757	1889	1929	1982
	yy = N° elem.		29													
<b>Lenght mm</b>	<b>1350</b>	W	609	975	1119	1162	1261	1402	1541	1638	1677	1721	1817	1955	1996	2050
	yy = N° elem.		30													
<b>Lenght mm</b>	<b>1395</b>	W	629	1008	1156	1200	1303	1448	1592	1693	1733	1778	1878	2020	2062	2119
	yy = N° elem.		31													
<b>Lenght mm</b>	<b>1440</b>	W	649	1040	1194	1239	1345	1495	1644	1747	1789	1836	1939	2085	2129	2187
	yy = N° elem.		32													
<b>Lenght mm</b>	<b>1485</b>	W	670	1073	1231	1278	1387	1542	1695	1802	1845	1893	1999	2150	2195	2255
	yy = N° elem.		33													
<b>Lenght mm</b>	<b>1530</b>	W	690	1105	1268	1316	1429	1588	1747	1856	1901	1951	2060	2215	2262	2324
	yy = N° elem.		34													
<b>Lenght mm</b>	<b>1575</b>	W	710	1138	1306	1355	1471	1635	1798	1911	1957	2008	2120	2280	2328	2392
	yy = N° elem.		35													
<b>Lenght mm</b>	<b>1620</b>	W	730	1170	1343	1394	1513	1682	1849	1966	2012	2065	2181	2345	2395	2460
	yy = N° elem.		36													
<b>Lenght mm</b>	<b>1665</b>	W	751	1203	1380	1433	1555	1729	1901	2020	2068	2123	2241	2411	2461	2529
	yy = N° elem.		37													
<b>Lenght mm</b>	<b>1710</b>	W	771	1235	1417	1471	1597	1775	1952	2075	2124	2180	2302	2476	2528	2597
	yy = N° elem.		38													
<b>Lenght mm</b>	<b>1755</b>	W	791	1268	1455	1510	1639	1822	2003	2129	2180	2237	2363	2541	2594	2665
	yy = N° elem.		39													
<b>Lenght mm</b>	<b>1800</b>	W	812	1300	1492	1549	1681	1869	2055	2184	2236	2295	2423	2606	2661	2734
	yy = N° elem.		40													

## RADIATORS' DATA (LENGHTS WITHOUT BUSHES)

		HEIGHT													
		750	765	815	865	885	900	1000	1200	1500	1800	2000	2200	2500	
<b>Lenght mm</b>	<b>90</b>	W	149	151	160	169	173	176	194	230	283	338	374	411	467
<i>yy = N° elem.</i>	2														
<b>Lenght mm</b>	<b>135</b>	W	223	227	240	254	259	263	290	344	425	507	562	617	701
<i>yy = N° elem.</i>	3														
<b>Lenght mm</b>	<b>180</b>	W	297	302	321	339	346	351	387	459	567	676	749	823	935
<i>yy = N° elem.</i>	4														
<b>Lenght mm</b>	<b>225</b>	W	372	378	401	423	432	439	484	574	709	845	936	1028	1169
<i>yy = N° elem.</i>	5														
<b>Lenght mm</b>	<b>270</b>	W	446	454	481	508	519	527	581	689	850	1014	1123	1234	1402
<i>yy = N° elem.</i>	6														
<b>Lenght mm</b>	<b>315</b>	W	521	529	561	592	605	615	678	803	992	1182	1310	1440	1636
<i>yy = N° elem.</i>	7														
<b>Lenght mm</b>	<b>360</b>	W	595	605	641	677	692	702	774	918	1134	1351	1498	1645	1870
<i>yy = N° elem.</i>	8														
<b>Lenght mm</b>	<b>405</b>	W	669	680	721	762	778	790	871	1033	1276	1520	1685	1851	2103
<i>yy = N° elem.</i>	9														
<b>Lenght mm</b>	<b>450</b>	W	744	756	801	846	864	878	968	1148	1417	1689	1872	2057	2337
<i>yy = N° elem.</i>	10														
<b>Lenght mm</b>	<b>495</b>	W	818	832	881	931	951	966	1065	1262	1559	1858	2059	2262	2571
<i>yy = N° elem.</i>	11														
<b>Lenght mm</b>	<b>540</b>	W	892	907	962	1016	1037	1054	1161	1377	1701	2027	2247	2468	2805
<i>yy = N° elem.</i>	12														
<b>Lenght mm</b>	<b>585</b>	W	967	983	1042	1100	1124	1141	1258	1492	1843	2196	2434	2674	3038
<i>yy = N° elem.</i>	13														
<b>Lenght mm</b>	<b>630</b>	W	1041	1058	1122	1185	1210	1229	1355	1607	1984	2365	2621	2879	3272
<i>yy = N° elem.</i>	14														
<b>Lenght mm</b>	<b>675</b>	W	1116	1134	1202	1270	1297	1317	1452	1721	2126	2534	2808	3085	3506
<i>yy = N° elem.</i>	15														
<b>Lenght mm</b>	<b>720</b>	W	1190	1210	1282	1354	1383	1405	1549	1836	2268	2703	2995		
<i>yy = N° elem.</i>	16														
<b>Lenght mm</b>	<b>765</b>	W	1264	1285	1362	1439	1469	1493	1645	1951	2410	2872	3183		
<i>yy = N° elem.</i>	17														
<b>Lenght mm</b>	<b>810</b>	W	1339	1361	1442	1524	1556	1580	1742	2066	2551	3041	3370		
<i>yy = N° elem.</i>	18														
<b>Lenght mm</b>	<b>855</b>	W	1413	1436	1522	1608	1642	1668	1839	2180	2693	3209	3557		
<i>yy = N° elem.</i>	19														
<b>Lenght mm</b>	<b>900</b>	W	1487	1512	1603	1693	1729	1756	1936	2295	2835	3378	3744		
<i>yy = N° elem.</i>	20														
<b>Lenght mm</b>	<b>945</b>	W	1562	1588	1683	1777	1815	1844	2033	2410	2977	3547	3931		
<i>yy = N° elem.</i>	21														
<b>Lenght mm</b>	<b>990</b>	W	1636	1663	1763	1862	1902	1932	2129	2525	3118	3716	4119		
<i>yy = N° elem.</i>	22														
<b>Lenght mm</b>	<b>1035</b>	W	1711	1739	1843	1947	1988	2019	2226	2639					
<i>yy = N° elem.</i>	23														
<b>Lenght mm</b>	<b>1080</b>	W	1785	1814	1923	2031	2075	2107	2323	2754					
<i>yy = N° elem.</i>	24														
<b>Lenght mm</b>	<b>1125</b>	W	1859	1890	2003	2116	2161	2195	2420	2869					
<i>yy = N° elem.</i>	25														
<b>Lenght mm</b>	<b>1170</b>	W	1934	1966	2083	2201	2247	2283	2517						
<i>yy = N° elem.</i>	26														
<b>Lenght mm</b>	<b>1215</b>	W	2008	2041	2164	2285	2334	2371	2613						
<i>yy = N° elem.</i>	27														
<b>Lenght mm</b>	<b>1260</b>	W	2082	2117	2244	2370	2420	2458	2710						
<i>yy = N° elem.</i>	28														
<b>Lenght mm</b>	<b>1305</b>	W	2157	2192	2324	2455	2507	2546	2807						
<i>yy = N° elem.</i>	29														
<b>Lenght mm</b>	<b>1350</b>	W	2231	2268	2404	2539	2593	2634	2904						
<i>yy = N° elem.</i>	30														
<b>Lenght mm</b>	<b>1395</b>	W	2305	2344	2484	2624	2680	2722	3000						
<i>yy = N° elem.</i>	31														
<b>Lenght mm</b>	<b>1440</b>	W	2380	2419	2564	2708	2766	2810	3097						
<i>yy = N° elem.</i>	32														
<b>Lenght mm</b>	<b>1485</b>	W	2454	2495	2644	2793	2853	2897	3194						
<i>yy = N° elem.</i>	33														
<b>Lenght mm</b>	<b>1530</b>	W	2529	2570	2724	2878	2939	2985	3291						
<i>yy = N° elem.</i>	34														
<b>Lenght mm</b>	<b>1575</b>	W	2603	2646	2805	2962	3025	3073	3388						
<i>yy = N° elem.</i>	35														
<b>Lenght mm</b>	<b>1620</b>	W	2677	2722	2885	3047	3112	3161	3484						
<i>yy = N° elem.</i>	36														
<b>Lenght mm</b>	<b>1665</b>	W	2752	2797	2965	3132	3198	3249	3581						
<i>yy = N° elem.</i>	37														
<b>Lenght mm</b>	<b>1710</b>	W	2826	2873	3045	3216	3285	3336	3678						
<i>yy = N° elem.</i>	38														
<b>Lenght mm</b>	<b>1755</b>	W	2900	2948	3125	3301	3371	3424	3775						
<i>yy = N° elem.</i>	39														
<b>Lenght mm</b>	<b>1800</b>	W	2975	3024	3205	3386	3458	3512	3872						
<i>yy = N° elem.</i>	40														

