



**Technical features:**

- steel towel warmer radiator
- horizontal elements featuring with a 23 mm diameter
- side round manifolds with a 30 mm diameter
- manifold threading 1/2" Gas right
- maximum working pressure 8 bar
- maximum working temperature 95°C
- 50 mm connection
- radiator hydraulic equipped with a booster mounted behind the radiator with a power of 1,000 watts.
- not suitable for installation with a single-pipe system

**Price included:**

- 4 wall fixing in the same color as the radiator
- 2 1/2" hidden air vents complete with valve cover

Finishes available	Surcharge
Standard White	
Classic finished	
Special finished	
Other RAL colors	

Finishing codes see page 596.



**50 mm Connection**

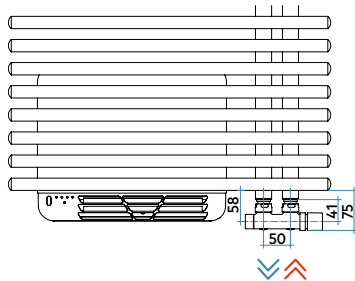

Type with collectors on the right  
Hydraulic connection 50 mm

**Connection dimensions with IRSAP valves**

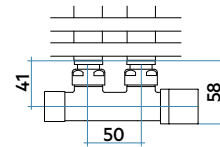

**Booster**



**MAIN CHARACTERISTICS OF AIR DIFFUSER**

- ON/OFF switch
- Power supply 230 V 50 Hz, 1 ph
- Power installed = 1000 W
- Insulation: CLASSE II
- Connecting to a network equipment that comes with the phase and neutral version without plug or with Schuko plug
- Protection index: IP24
- Long electricity cable: 1.200 mm
- Electronic ambient thermostat

# FUNKY\_S AIR MIX

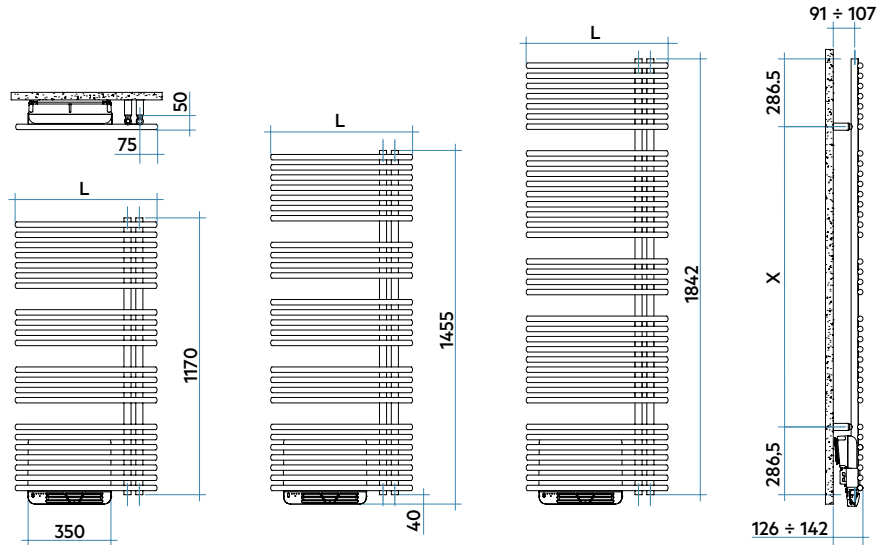

L mm	H mm	X mm
600	1170	597
600	1455	882
600	1842	1269



Model	Code	Depth P mm	Height H mm	Width L mm	Conn. C. L' mm	Weight Kg	Cap. lt	Thermal Power				Auxiliary heater		
								$\Delta t=50^{\circ}\text{C}$ Btu/h	$\Delta t=40^{\circ}\text{C}$ Watt	$\Delta t=30^{\circ}\text{C}$ Watt (*)	$\Delta t=20^{\circ}\text{C}$ Watt	Exp. n.	with diffuser Watt	
1170 22 rails 3 espaces	<b>YBM060 B 01 IR 01 NNN</b>	122	1210	600	50	14,8	4,7	1952	<b>572</b>	439	<b>311</b>	192	1,190	+ 1000
1455 27 rails 4 espaces	<b>YBL060 B 01 IR 01 NNN</b>	122	1495	600	50	17,5	5,8	2347	<b>688</b>	521	<b>364</b>	220	1,246	1000
1842 36 rails 4 espaces	<b>YBG060 B 01 IR 01 NNN</b>	122	1882	600	50	21,8	7,6	3039	<b>891</b>	676	<b>473</b>	286	1,238	1000

(\*) Thanks to the high performance of Irsap FUNKY\_S AIR MIX radiators, the ideal  $\Delta t$  for low temperature projects is  $\Delta t$  at  $30^{\circ}\text{C}$ .

For  $\Delta t$  different from  $50^{\circ}\text{C}$  use the formula:  $Q=Q_n (\Delta t / 50)^n$

## Key Codes

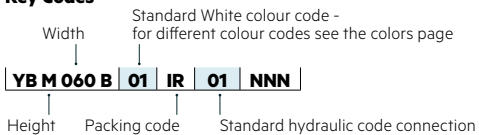

BATHROOMS  
RADIATORS

## Decorative & Technical Accessories

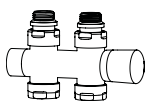

Kit Valves and Lockshield valve  
Pag. 562

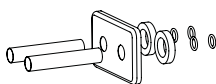

Pipe cover kit  
Pag. 566

## Wireless Remote Control (optional) for booster control

FUNKY\_S Air Mix is equipped with a controller that allows remote management of every electric radiator function. Because the controller is wireless, it has the advantage of being quick and easy to install and does not require any modifications within the home.

### REELETRAS2501N

#### Technical specifications

- Wireless communication via radio signals transmitted to the receiver connected to the system.
- Approx. 30-50 metre range in residential environments (868 MHz).
- Radiofrequency communication pursuant to European standards.
- You can activate the manual functions

